

SGB 501W Water-Cooled Mig Welding Torch
 Rating: 500A CO₂ 450A mixed gas, EN60974-7 @ 100% duty cycle. 1.0 to 1.6mm wires

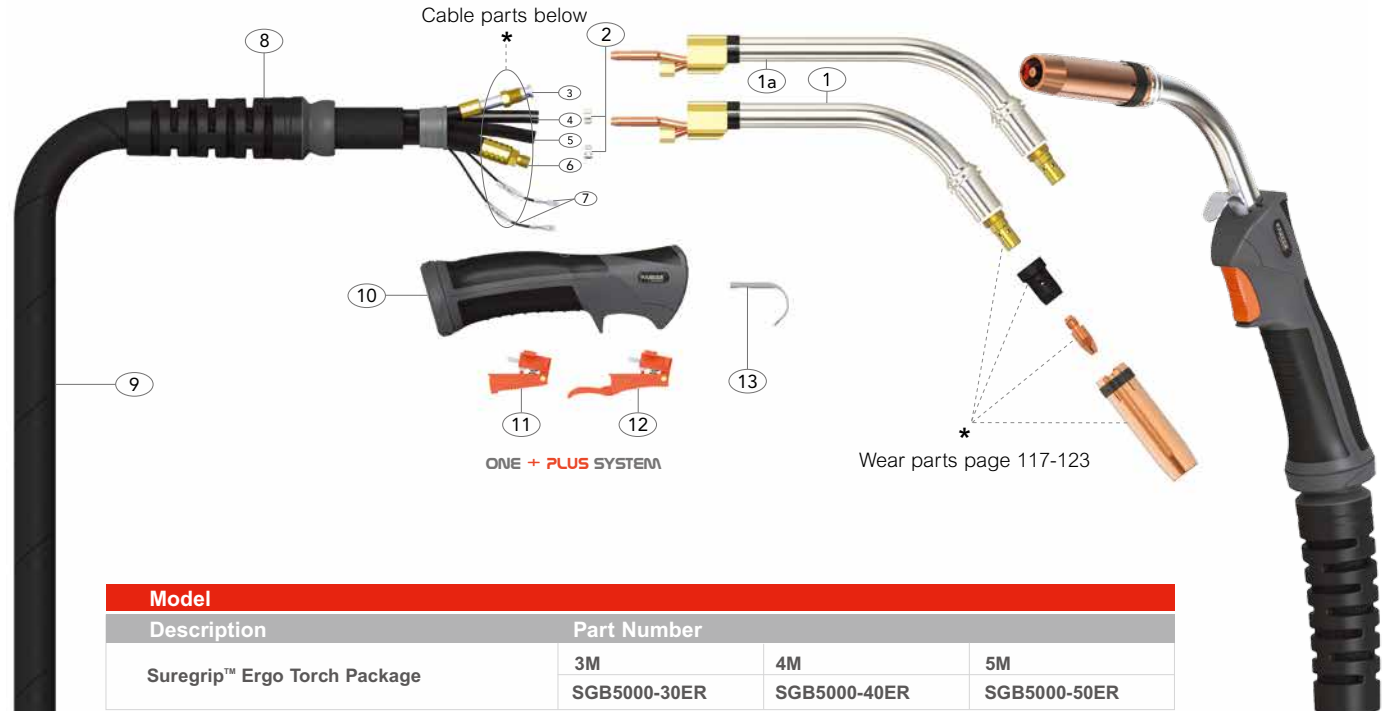

Model			
Description	Part Number		
Suregrip™ Ergo Torch Package	3M	4M	5M
	SGB5000-30ER	SGB5000-40ER	SGB5000-50ER

Spare parts			
Part Number	Description	Part Number	Description
1	PG5002 Swan Neck Assembly	22	PBD-80320 Red Cap Stopper
1a	PG5002L Swan Neck Assembly Long	23	PS5017 Water Outlet Hose O/braid Rubber
2	PB5041 Hose Clamp 8.7mm	24	PB1526 Gun Plug Screw
8	PG3208 Handle Cable Support	25	PB1519/S Gun Plug Nut
9	PS5006-30 Cable Assembly X 3mt	26	PB1522 Cable Terminal Male
	PS5006-40 Cable Assembly X 4mt	27	PB5024 Hose Clamp 9.5mm
	PS5006-50 Cable Assembly X 5mt	28	PB1523 Gun Plug Terminal Female
10	SGB2514 Ergo Handle Kit C/W Lock Nut	29	PB5098 Gun Plug Body C/W Spring Pins
11	DGB2516 Standard Trigger Assembly	30	PB1524 Gun Plug 'O' Ring
12	DGB2516L Extended Trigger Assembly	31	PB1525 Liner Nut
13	PB2517 Hanger Hook (Optional Extra)		
14	PC8027 Housing Spring		
15	PT8028 Spring Cable Support Nut		
16	PT8009 Canvas Cover Clamp		
17	PT8010 Canvas Cover Retainer		
18	PT5022 Gun Plug Housing Assembly		
19	PSLH1820-S Inlet/Outlet Hose Support		
20	PB5023 Water Hose Nipple		
21	PBD-80310 Blue Cap Stopper		

Cable parts			
Description	Part Number		
	3M	4M	5M
3 Outer Liner Assembly	PS5008-30	PS5008-40	PS5008-50
4 Gas Hose Assembly	PS5013-30	PS5013-40	PS5013-50
5 Water Inlet Hose Assembly	PS5012-30	PS5012-40	PS5012-50
6 Power Cable Assembly	PS5015-30	PS5015-40	PS5015-50
7 Switch Lead Assembly	PS5010-30	PS5010-40	PS5010-50

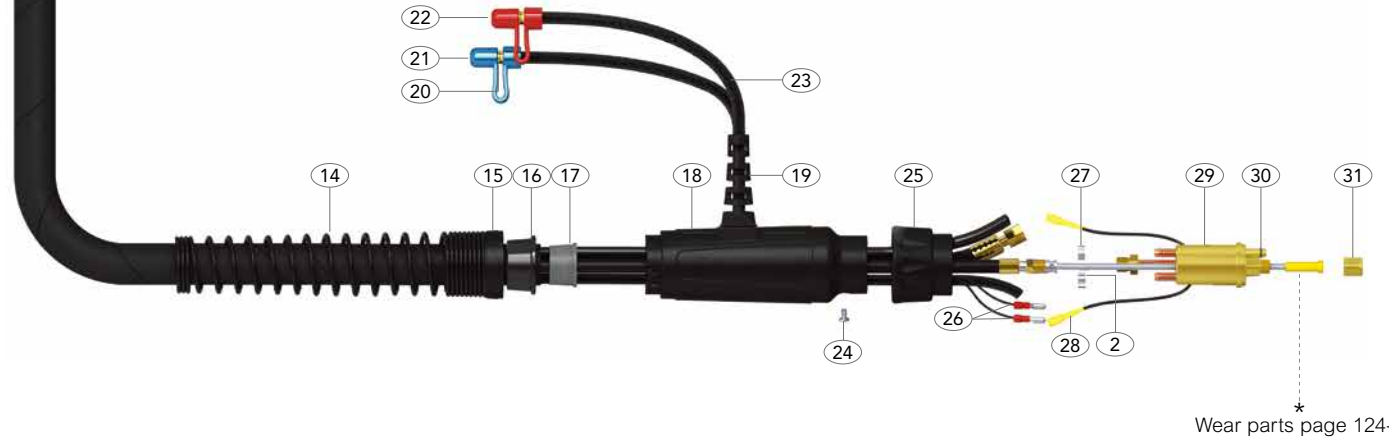

Wear parts page 124-128