

# M5 Air-Cooled Mig Welding Torch

Ratings:	390A CO <sub>2</sub> , 360A mixed gas M21, EN60974-7 @ 60% duty cycle. 0.9mm-1.6mm wires
----------	---

Constructed for power, performance, and longevity the M5 is ideal for heavy duty 1.2mm and 1.6mm high deposition and pulse applications.

High tech control of welding parameters is made by digitally interfacing control features from the torch handle.



M5 Video

## ARC M MACHINE CONTROL MIG TORCH PACKAGES

M5 Torches are supplied with a Euro termination as standard and are supplied 'ready to weld' with all wear parts fitted.

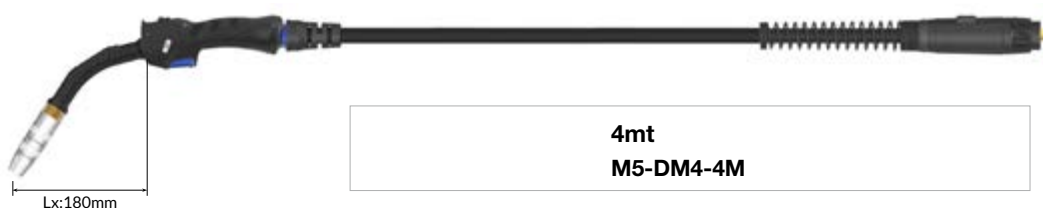

### Wear Parts



#### Nozzle - 2 Piece

Part Number	Description	Bore	Wall	Material
A AM5HDTN	Tapered Nozzle - (Part 2)	13mm	3.5mm	Copper
•AM5HDCN	Conical Nozzle - (Part 2)	15mm	3.5mm	Copper
AM5HDCYN	Cylindrical Nozzle - (Part 2)	21mm	3.5mm	Copper
A1•AM5HDNI	Nozzle Insulator - (Part 1)			Copper

#### Nozzle - Single Piece

A2 AM5TN	Tapered Nozzle / Insulator Assy	13mm	2.5mm	Copper
AM5CN	Conical Nozzle / Insulator Assy	15mm	2.5mm	Copper
AM5CYN	Cylindrical Nozzle / Insulator Assy	21mm	2.5mm	Copper

#### B Contact Tips

Part Number	Description	Size (mm)	Wire Size (mm-inch)	Material
<b>Standard Series</b>				
AM6WCT09	Contact Tip	M10*35.5	0.9 - 0.035	CuCrZr
AM6WCT10	Contact Tip	M10*35.5	1.0 - 0.040	CuCrZr
•AM6WCT12	Contact Tip	M10*35.5	1.2 - 0.045	CuCrZr
AM6WCT14	Contact Tip	M10*35.5	1.4 - 0.055	CuCrZr
AM6WCT16	Contact Tip	M10*35.5	1.6 - 0.063	CuCrZr
AM6WCT20	Contact Tip	M10*35.5	2.0 - 0.080	CuCrZr
<b>A Series</b>				
AM6WCT10A	Contact Tip	M10*35.5	1.0 - 0.040	CuCrZr
AM6WCT12A	Contact Tip	M10*35.5	1.2 - 0.045	CuCrZr
AM6WCT16A	Contact Tip	M10*35.5	1.6 - 0.063	CuCrZr
AMC6WCT10A	Contact Tip	M10*35.5	1.0 - 0.040	Copper
AMC6WCT12A	Contact Tip	M10*35.5	1.2 - 0.045	Copper

#### Tip Adaptors

Part Number	Description	Material
AM5TAC	Tip Adaptor High Performance	CuCrZr
•AM5TAB	Tip Adaptor	Brass

#### D Liners

Part Number	Description	Wire Size
•AM6SL-1012-30	Steel Liner x 3mt	1.0-1.2mm
•AM6SL-1012-40	Steel Liner x 4mt	1.0-1.2mm
•AM6SL-1012-50	Steel Liner x 5mt	1.0-1.2mm
AM6SL-16-30	Steel Liner x 3mt	1.6mm
AM6SL-16-40	Steel Liner x 4mt	1.6mm
AM6SL-16-50	Steel Liner x 5mt	1.6mm

• Denotes torch package standard wear part set-up

**SuperSoft -20 Premium Power Cables**  
Perfect for extreme subzero working conditions

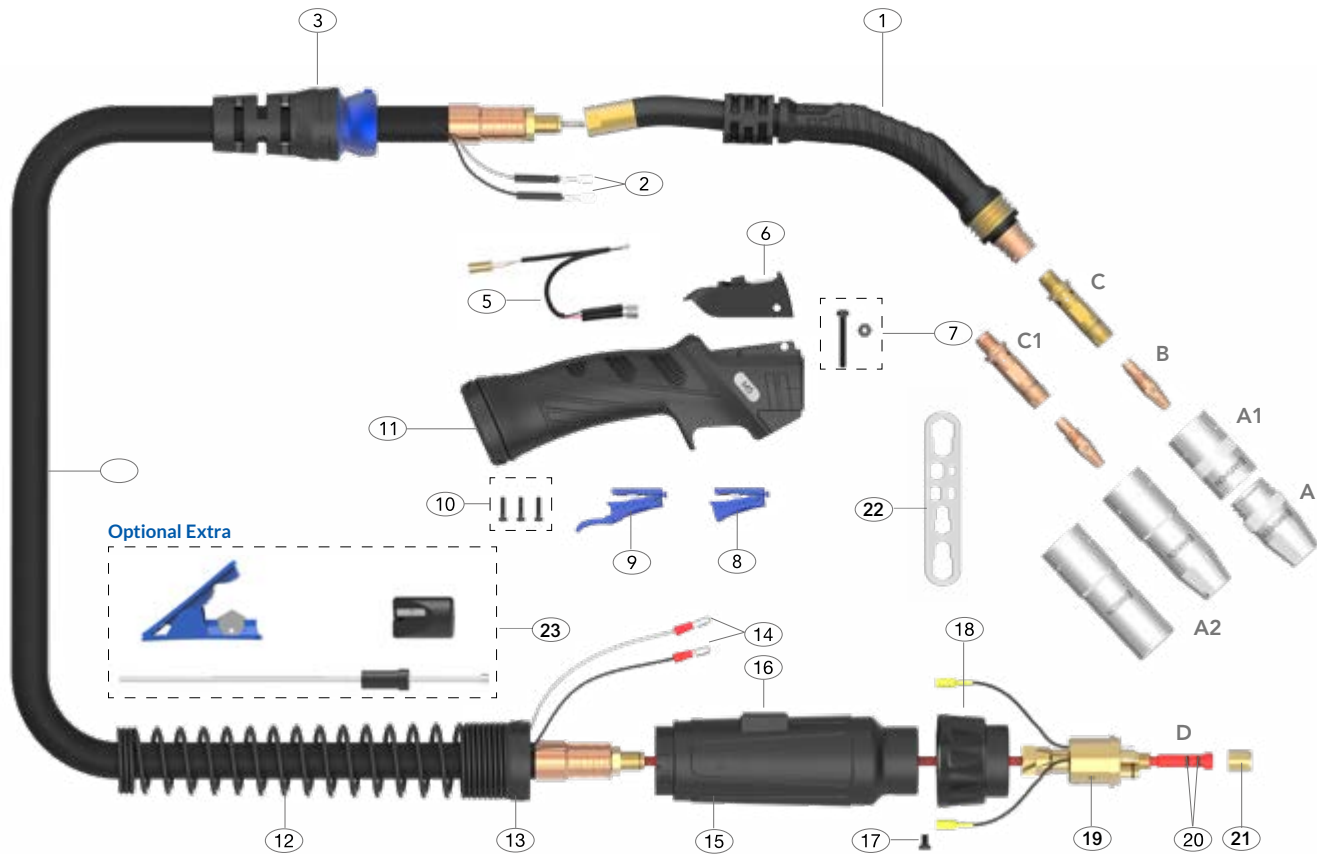

## Spare Parts

Part Number	Description
1	AM5001 Swan Neck Assembly
2	AM1521 Cable Terminal
3	AMS8017 Handle Cable Support c/w Ball Joint
4	AM5003CW-30 Power Cable Assembly x 3mt
	AM5003CW-40 Power Cable Assembly x 4mt
	AM5003CW-50 Power Cable Assembly x 5mt
5	AMCW Module Wiring Harness
7	AMDMNS Screw and Nut
8	AM2516 Microswitch Standard Trigger
9	AM2516L Microswitch Extended Trigger
10	AMSP1-1 Screw Pack
11	AM2515 Handle and Lock Nut Assembly
12	AM8026 Housing Spring
13	AM8028 Housing Lock Nut
14	AM1522 Cable Terminal Male

Part Number	Description
15	AMT5022 Gun Plug Housing
16	AMF8017 Large Housing Flat Cover Block
17	AM1526 Gun Plug Screw
18	AM1519 Gun Plug Nut
19	AMB1528 Gun Plug Body
20	AMLOR Liner 'O' Ring
21	AM1826 Liner Retaining Nut
22	AMWS Wear Parts Spanner
<b>Optional Extra</b>	
23	AMCLST-KITS Combi-Liner Set-up kit

### Welding with Soft Wires

For welding with Aluminum wires use a Combi-Liner (page 50-51). Optimum installation is achieved when using the Combi-Liner set-up kit.